

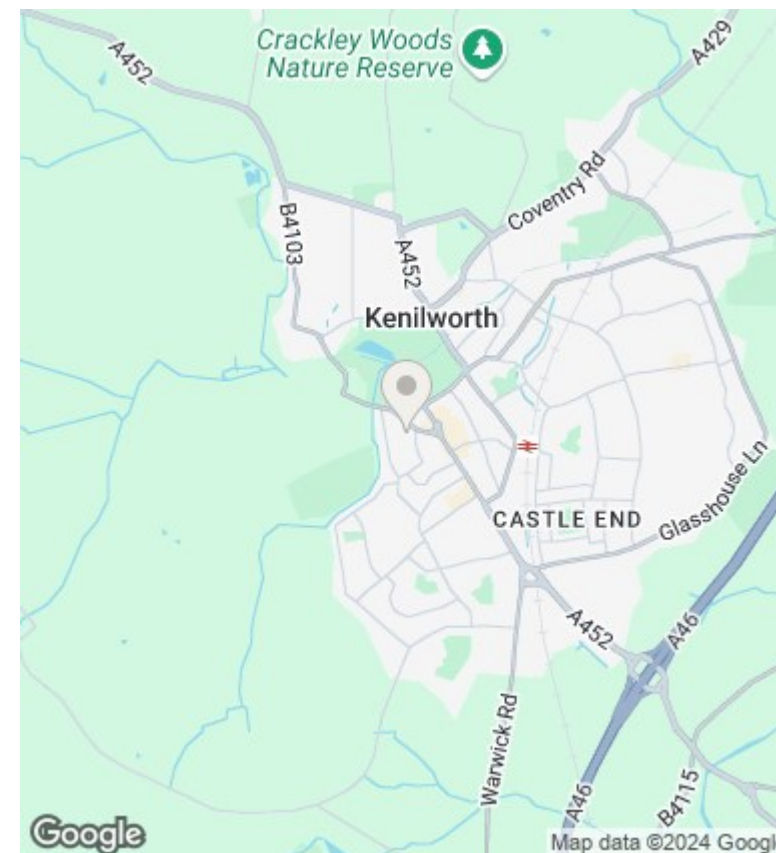

## 3 Mulberry Court, Kenilworth, CV8 1LG

£1,200 PCM

- Town Centre Apartment
- EPC Rating B
- Allocated and Visitor Parking
- Available 6th January 2025
- Large First Floor Apartment
- Gas Central Heating with Combi Boiler
- Lounge/ Dining Room
- Two Bedrooms/Two Bathrooms
- Secure Intercom Entrance
- Adjacent to The Abbey Fields

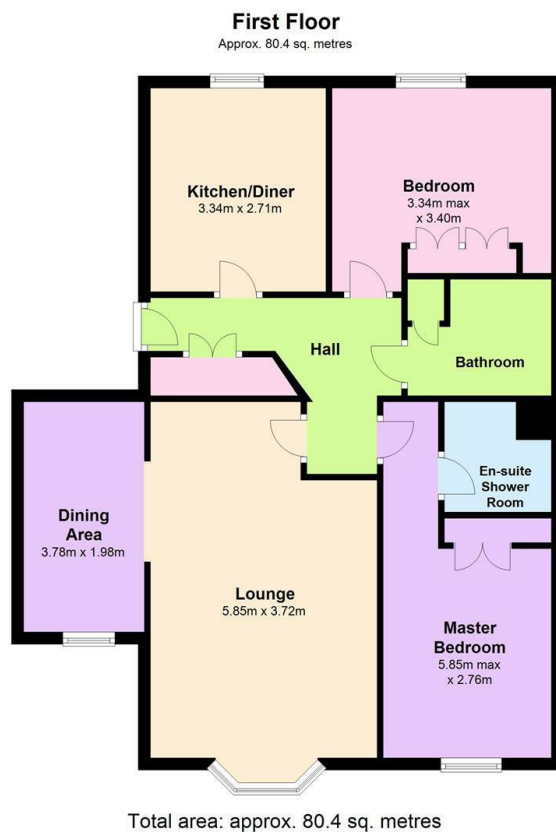

## Directions

## Viewings

Viewings by arrangement only. Call 01926 857244 to make an appointment.

## Council Tax Band

C

## EPC Rating:

B

Energy Efficiency Rating		
	Current	Potential
Very energy efficient - lower running costs		
(92-plus) <b>A</b>		
(81-91) <b>B</b>	81	82
(69-80) <b>C</b>		
(55-68) <b>D</b>		
(39-54) <b>E</b>		
(21-38) <b>F</b>		
(1-20) <b>G</b>		
Not energy efficient - higher running costs		
<b>England &amp; Wales</b>	EU Directive 2002/91/EC	